

# AIE110-ONX NEW

Edge AI Developer Kit with NVIDIA® Jetson Orin™ NX SoM, 1 HDMI, 1 GbE LAN, 1 GbE PoE, and 2 USB

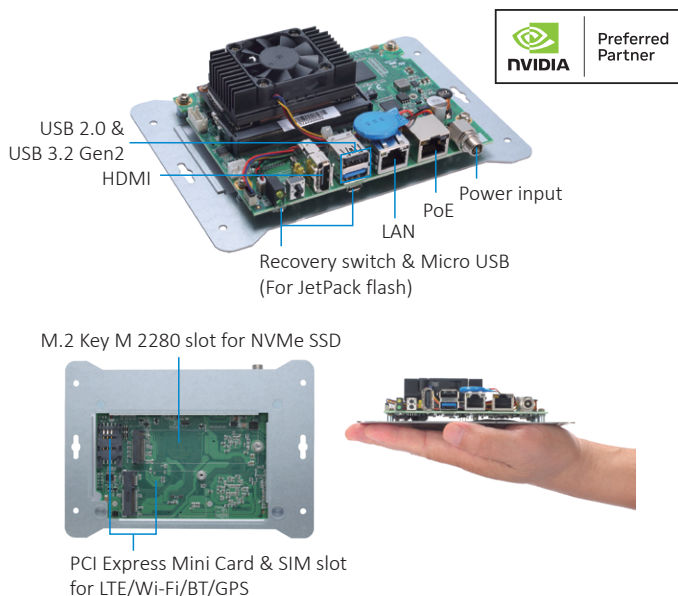

## Features

- NVIDIA® Jetson Orin™ NX (up to 100 TOPS)
- 1 USB 2.0, 1 USB 3.2 Gen2, 1 GbE LAN
- Supports one 15W GbE PoE for camera
- 1 M.2 Key M NVMe SSD slot
- 1 PCI Express Mini Card slot for Wi-Fi/Bluetooth/LTE/GPS
- JetPack supported
- Supports 24/7 secure remote monitoring, control, and OTA deployment empowered by Allxon

NVIDIA® Jetson Orin™ NX available through to 2030\*  
The official end of life notice will be sent for at least 8 months before the last shipment.



## Specifications

AI Accelerator	NVIDIA® Jetson Orin™ NX
CPU	16GB: 8-core NVIDIA Arm® Cortex A78AE v8.2 64-bit CPU 2MB L2 + 4MB L3 8GB: 6-core NVIDIA Arm® Cortex A78AE v8.2 64-bit CPU 1.5MB L2 + 4MB L3
GPU	1024-core NVIDIA Ampere architecture GPU with 32 Tensor Cores
System Memory	16GB: 16GB 128-bit LPDDR5 onboard 8GB: 8GB 128-bit LPDDR5 onboard
Carrier Board	SBC87903
System I/O Outlet	1 x HDMI 2.1 with 4K2K supported 1 x 10/100/1000 Mbps Ethernet (via Jetson Orin™ NX) 1 x 10/100/1000 Mbps PoE (Intel® I210-IT; max. up to 15W) 1 x USB 3.2 Gen2, 1 x USB 2.0 1 x DIO (pin header) 1 x Micro USB 1 x Recovery switch 1 x Reset button 1 x Power button 1 x 12 VDC power input connector
Watchdog Timer	Built-in Orin™ NX
Storage	1 x M.2 Key M 2280 with PCIe x4 NVMe SSD slot *Orin NX no longer has built-in eMMC and only supports SSD for the bootable device. *The AIE110-ONX requires an SSD for image installation. Kindly order the SSD if you need image installation service.
Expansion Interface	1 x Full-size PCI Express Mini Card slot (USB + PCI Express signal) 1 x SIM slot
System Indicator	1 x Green LED for system power-on 1 x Yellow LED for M.2 storage
Power Supply	12 VDC screw type
Operating Temperature	-10°C to +60°C (14°F to +140°F)
Humidity	10% - 95%, non-condensing
Vibration Endurance	3 Grms with M.2 (5 to 500Hz, X, Y, Z directions)
Dimensions	165 mm (6.49") (W) x 117 mm (4.60") (D) x 37.7 mm (1.48") (H)
Weight (net/gross)	0.3 kg (0.66 lb)/ 0.9 kg (1.98 lb)
Certifications	CE
OS Support	Linux Ubuntu 20.04 or later

---

## Remote Management Enrollment

Allxon Portal - Enroll in 24/7 secure service to get the full feature of remote device management on one centralized cloud portal

\*Enrollment Page: [https://allxon.com/jetson/device\\_enroll/](https://allxon.com/jetson/device_enroll/)

---

## Packing List

1 x DIO cable

---

## Power Protection

### DC Adapter

OVP (over voltage protection)

OCP (over current protection)

UVP (under voltage protection)

SCP (short circuit protection)

---

## Ordering Information

### Standard

AIE110-ONX-16GB	Edge AI developer kit with NVIDIA® Jetson Orin™ NX 16GB, 1 HDMI, 1 GbE LAN, 1 GbE PoE and 2 USB
-----------------	---

AIE110-ONX-8GB	Edge AI developer kit with NVIDIA® Jetson Orin™ NX 8GB, 1 HDMI, 1 GbE LAN, 1 GbE PoE and 2 USB
----------------	--

### Optional

M.2 NVMe SSD 128GB or above

\*The AIE110-ONX requires an SSD for image installation. Kindly order the SSD if you need image installation service.

LTE module

Wi-Fi module

Power cord

50966124050E	12V/60W adapter
--------------	-----------------

\* Specifications and certifications may vary based on different requirements.

## Dimensions

